

03 DOOR JAMB NON-MOTORIZED
SCALE: 1-1/2" = 1'

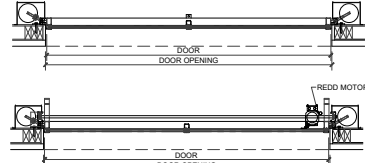

02 DOOR PLAN MOTORIZED & NON
SCALE: 1/2" = 1'



01 DOOR JAMB MOTORIZED
SCALE: 1-1/2" = 1'

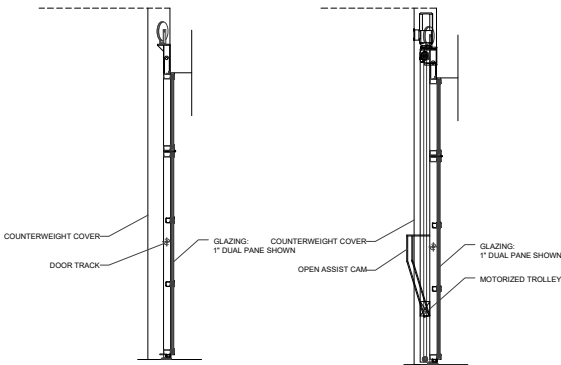

06 DOOR HEAD - SILL TYP
SCALE: 1-1/2" = 1'

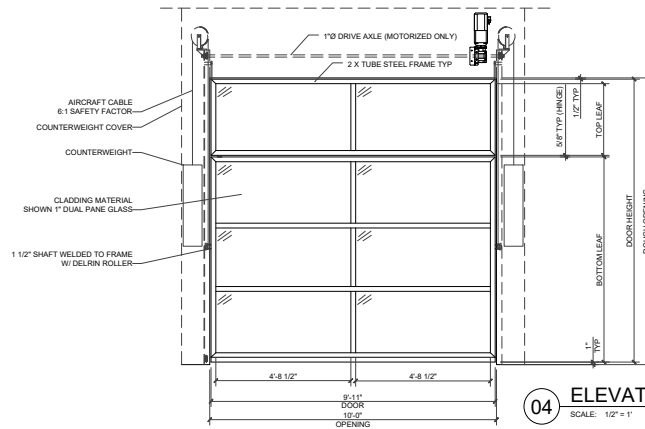

04 ELEVATION & SECTIONS MOTORIZED & NON
SCALE: 1/2" = 1'

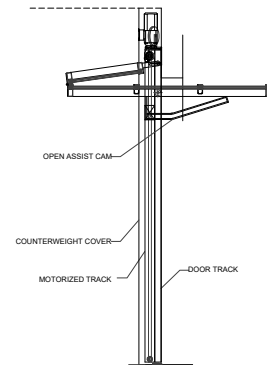

GLAZING OPTIONS:

1/4" to 1" POLYCARBONATE
1/4" to 1" LAMINATED
1/4" to 1" TEMPERED
1" INSULATED

COLOR / FINISH OPTIONS:

CUSTOM COLOR MATCHING
CUSTOM CLADDING
POWDER COATING
GALVANIZED

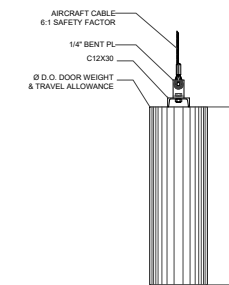

08 COUNTERWEIGHT TYP
SCALE: 1-1/2" = 1'

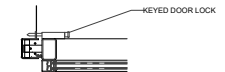

09 LOCK TYP (MANUAL ONLY)
SCALE: 1-1/2" = 1'

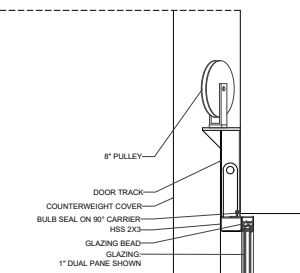

05 DOOR HEAD NON MOTORIZED
SCALE: 1-1/2" = 1'

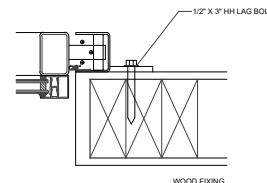

07 FIXING DETAILS TYP
SCALE: 3" = 1'

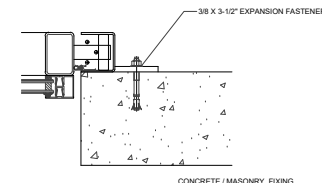

BSJ FIXING

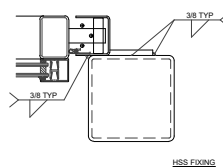

HSS FIXING

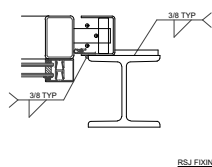

BSJ FIXING

"DISCLAIMER"
THE DESIGNS AND DETAILS HEREIN ARE THE PROPERTY OF RENLITA DOORS NORTH AMERICA. USE IS GRANTED FOR THE SOLE PURPOSE OF INTEGRATION OF OUR PRODUCT INTO YOUR PROJECT. DRAWINGS ARE TYPICAL IN NATURE AND FOR REFERENCE ONLY, AND SHOULD BE REGARDED AS SUCH, DUE TO THE CUSTOM NATURE OF OUR PRODUCT SPECIFIC CONFIGURATIONS AND DIMENSIONS MAY VARY.

RENLITA OVERHEAD DOORS®

P.O. Box B
220 E. First Street
Bonham, Texas 75418
Phone: 903-563-7500 Fax: 903-563-7544
www.renlitadoors.com

Project: SERIES 2000 TYPICAL
Project No.:
Client: -
Install Date: -
Label Rev: Date:
Drawn By: JDC

Drawing No.:
2K
1"